



ActivPanel

INTERACTIVE FLAT PANELS

55", 65", 75" and 84"

DESCRIPTION

Introducing the ActivPanel, the next generation interactive flat panel with Full HD and 4K Ultra HD displays designed to enhance the classroom viewing experience and interaction amongst students.

AT A GLANCE

BRILLIANT PICTURE QUALITY



Available in Full HD or 4K Ultra HD displays that ensure the entire class has an optimal viewing experience.

ENGAGING LESSONS



Create and deliver interactive lessons and assessments with our award-winning software, ClassFlow and ActivInspire.

SEAMLESS TEACHING & LEARNING EXPERIENCE



Our external Wi-Fi-enabled Android™ device, included with the ActivPanel, enables wireless mirroring of mobile devices onto the ActivPanel. Instantly you can download and use your favorite apps from any Android App Store, launch the Instant Whiteboard to write or draw, and wirelessly share lesson content.

INSTANT COLLABORATION & INTERACTIVITY



Multi-user interactivity with 10 simultaneous touch points and 1 digital pen. Our ActivGlide Technology™ delivers smooth interactivity at the touch of a finger.

BEST-IN-CLASS CONNECTIVITY



Offers a variety of ports for convenient peripheral connectivity, including 4 HDMI ports, 4 USB touch, 2 OPS slots, VGA, Audio, Source Switched USB HUB and more.

MOVE FREELY THROUGHOUT THE CLASSROOM



Easily connect mobile devices using the dual network capability. Teachers can take advantage of the wireless mirroring to share their content from anywhere in the room.

INTELLIGENT DESIGN



Innovation in computing power doubles every 2 years. We will ensure that you have the latest and greatest by offering an upgrade program that allows you to replace your existing Promethean Android device with the most up-to-date technology.

DEPENDABLE



The ActivPanel is built to last. The expected life of the ActivPanel light source is ten times that of a standard projector light source.

GENERAL SPECIFICATIONS

DISPLAY

| | |
|---|---|
| Glass Type | 4mm acid-etched tempered glass |
| Glass Hardness | 7 Mohs |
| Anti-Reflection, Glare & Friction Technology | ActivGlide™ Surface Technology |
| Panel Grade | Commercial Grade A |
| Screen Type | TFT LCD |
| Lighting Design | Direct LED Backlight |
| Aspect Ratio | 16:9 |
| Pixel Response Time | As low as 5 ms |
| Refresh Rate | HD 60 Hz, UHD 120 Hz |
| Display Colours | HD up to 16.7 Million, UHD up to 1.07 Billion |
| Brightness | Up to 450 NIT |
| Contrast Ratio | Up to 5000:1 |
| Viewing Angle | 178° |
| Backlight Life Time | Up to 50,000 hours |

INTERACTIVITY

| | |
|---|---|
| Compatibility | Windows 7 to 10 Mac OS X 10.6 - 10.11 Linux Ubuntu 12.04 - 14.04 Chromebook with touch |
| Continuous Touch Points | 10 |
| Digital Pen | 1 |
| Gestures and Edge Swipes | Win 8.1 Optimised & MacBook |
| USB HID Pen & Touch Compatible | Yes |
| Touch Technology | Infrared |
| Touch Resolution | Up to 32,768 x 32,768 |
| Bezel Size | 26 mm |
| Positioning Accuracy | <2mm |
| Tracking Rate | > 200 in / sec |
| First Touch Response | 6 ms |
| Subsequent Touch | 3 ms |
| Response Scan Speed | 6 ms |

ActivPanel v4 SS 04/16 V6.3 EN

GENERAL SPECIFICATIONS

AUDIO

| | |
|-----------------|-------------------------------|
| Speakers | Dual downward facing speakers |
| Power | 2 x 20 Watts |

CONNECTIVITY

Inputs

| | |
|------------------------|-----|
| HDMI 2.0 | x 4 |
| USB Touch | x 4 |
| VGA (D-Sub) via Dongle | x 1 |
| DP ++ via Dongle | x 1 |
| PC Audio (3.5 mm) | x 2 |
| USB 3.0 (HD Media) | x 2 |
| OPS Slots | x 2 |
| RS232 Serial | x 1 |

Outputs

| | |
|------------------------|----------------------------|
| HDMI 2.0 | x 1 (Switches with Source) |
| SPDIF Digital Audio | x 1 |
| Headphone | x 1 |
| RS232 Serial | x 1 |
| USB Pass Through Ports | x 2 |

EXTERNAL ANDROID

| | |
|-------------------------|---|
| System Version | Android 5.1 Lollipop |
| CPU | Rockchip RK3368 Octa Core up to 1.5GHz |
| GPU | SGX6110; support 4K*2K H.265/H.264 2GB DDR3 |
| RAM | 2GB |
| Internal Storage | 16GB |

POWER CONSUMPTION

| | |
|--------------------------|---------------------------------------|
| Standby Mode | <0.5W |
| Power Consumption | Backlight after 5 mins and ActivPanel |
| Auto Standby Mode | standby after 60 mins |

ENVIRONMENTAL

| | |
|------------------------------|-----------------------------|
| Operating Temperature | 5°C to 40°C (41°F to 104°F) |
| Storage Temperature | 2°C to 55°C (36°F to 131°F) |
| Operating Humidity | 20% to 80% humidity |
| Storage Humidity | 10% to 90% humidity |

DIGITAL PEN

| | |
|---------------------|--|
| Pen Function | HID pen digitiser or mouse Independent and non-concurrent of touch |
| Left Click | Mechanical tip switch |
| Right Click | Barrel button |
| Hover | Yes |
| Battery | AAA non-rechargeable |
| Battery Life | >1 year |
| Pen Storage | Pen holder attached to ActivPanel to protect pen and preserve battery life |

PACKED CONTENTS

| | |
|------------------------------|--------------------------|
| ActivPanel | x 1 |
| Digital Pen | x 1 |
| Stylus | x 2 |
| Wall Mount | x 1 |
| VESA Mount Bolts | x 4 |
| Remote Control | x 1 |
| Batteries | x 3 AAA |
| Power Cable | x 1 (3m UK, US, EU, AUS) |
| HDMI Cable + Fastener | x 1 (3m / 9.8ft) |
| USB Cable + Fastener | x 1 (3m / 9.8ft) |
| VGA Cable + Fastener | x 1 (3m / 9.8ft) |
| 3.5mm Audio Cable | x 1 (3m / 9.8ft) |
| Installation Guide | x 1 |
| User Guide | x 1 |

COMPLIANCE

& CERTIFICATION

| | |
|---------------------------------|-----------------------------------|
| Regulatory Certification | UL/CUL, FCC, IC, CE, CB, CCC, RCM |
|---------------------------------|-----------------------------------|

WARRANTY

| | |
|--------------------------|--|
| Standard Warranty | Three-Year Return for Repair Warranty |
| Extended Warranty | Purchasable Two-Year Extended Warranty |

INSTALLATION

The ActivPanel includes a fixed wall mount system. The installation of this product should be completed by a Trained Promethean Installer. Use of components not supplied by Promethean or not meeting minimum specifications may impact performance, safety and warranty. For more information, visit Support.PrometheanWorld.com

SUPPORT

For online support for all Promethean Products, please visit: Support.PrometheanWorld.com

STAND OPTIONS

Fixed Wall Mount: Included in box
Non-Adjustable Mobile Stand: Available in all markets
Adjustable Wall Mount, Tilt Frame Wall Mount & Mobile Stand: Available in specific markets

TECHNICAL SPECIFICATIONS BASED ON SIZE

| DISPLAY | | | | | | |
|-------------------------------|---|--|---|--|---|--|
| Diagonal Size | 55" HD | 65" HD | 75" HD | 65" 4K UHD | 75" 4K UHD | 84" 4K UHD |
| Optimum Resolution | Full HD 1080p 1920 x 1080 @ 60Hz | Full HD 1080p 1920 x 1080 @ 60Hz | Full HD 1080p 1920 x 1080 @ 60Hz | 4K UHD 2160p 3840 x 2160 @ 60Hz | 4K UHD 2160p 3840 x 2160 @ 60Hz | 4K UHD 2160p 3840 x 2160 @ 60Hz |
| Display Area | 1210mm x 680mm (47.6in x 26.7in) | 1428mm x 803mm (56.2in x 31.6in) | 1650mm x 928mm (65in x 36.5in) | 1428mm x 803mm (56.2in x 31.6in) | 1650mm x 928mm (65in x 36.5in) | 1867mm x 1053mm (73.5" x 41.5") |
| INTERACTIVITY | | | | | | |
| Output rate | 111Hz | 111Hz | 90Hz | 111Hz | 90Hz | 83Hz |
| PHYSICAL | | | | | | |
| Overall Dimensions | 1291.7 mm x 762.5 mm x 89.3 mm (50.8" x 30.0" x 3.5") | 1510.5 mm x 886.5 mm x 122 mm (59.5" x 34.9" x 4.8") | 1752.2 mm x 1005.7 mm x 110 mm (69.0" x 39.6" x 4.3") | 1510.5 mm x 886.5 mm x 122 mm (59.5" x 34.9" x 4.8") | 1752.2 mm x 1005.7 mm x 110 mm (69.0" x 39.6" x 4.3") | 1955.4 mm x 1141.4 mm x 98.8 mm (77.0" x 44.9" x 3.9") |
| Net Weight | 40.5 Kg (89.3 lbs) | 55.3 Kg (121.9 lbs) | 79 Kg (174.2 lbs) | 55.3 Kg (121.9 lbs) | 79 Kg (174.2 lbs) | 95.1 Kg (209.7 lbs) |
| Packed Weight | 58.1 Kg (128.1 lbs) | 71.3 Kg (157.2 lbs) | 102.5 Kg (226.0 lbs) | 71.3 Kg (157.2 lbs) | 102.5 Kg (226.0 lbs) | 123.5 Kg (272.3 lbs) |
| Packed Dimensions | 1530mm x 975mm x 260mm (60.2in x 38.3in x 10.2in) | 1765mm x 1165mm x 320mm (69.5in x 45.9in x 12.6in) | 1990 mm x 1165 mm x 320 mm (78.3" x 45.9" x 12.6") | 1765mm x 1165mm x 320mm (69.5in x 45.9in x 12.6in) | 1990 mm x 1165 mm x 320 mm (78.3" x 45.9" x 12.6") | 2200 mm x 1490 mm x 360 mm (86.6" x 58.7" x 14.2") |
| Power Requirements | AC 100~240V | AC 100~240V | AC 100~240V | AC 100~240V | AC 100~240V | AC 100~240V |
| VESA Mount Point (Wall/Stand) | 4 x M8 (VESA 400 x 400) | 4 x M8 (VESA 400 x 400) | 4 x M8 (VESA 600 x 400) | 4 x M8 (VESA 400 x 400) | 4 x M8 (VESA 600 x 400) | 4 x M8 (VESA 600 x 400) |
| VESA Mount Point (NUC/Mini) | 4 x M4 (VESA 100 and VESA 75, bracket not included) | 4 x M4 (VESA 100 and VESA 75, bracket not included) | 4 x M4 (VESA 100 and VESA 75, bracket not included) | 4 x M4 (VESA 100 and VESA 75, bracket not included) | 4 x M4 (VESA 100 and VESA 75, bracket not included) | 4 x M4 (VESA 100 and VESA 75, bracket not included) |

ACTIVPANEL HD 55" TECHNICAL DRAWING

FRONT

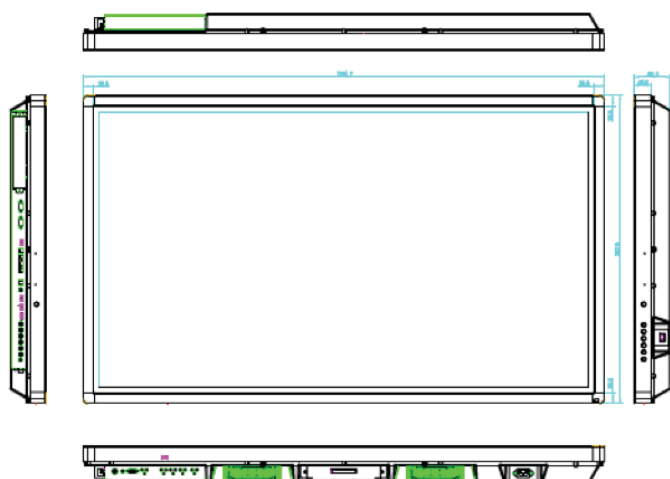

BACK

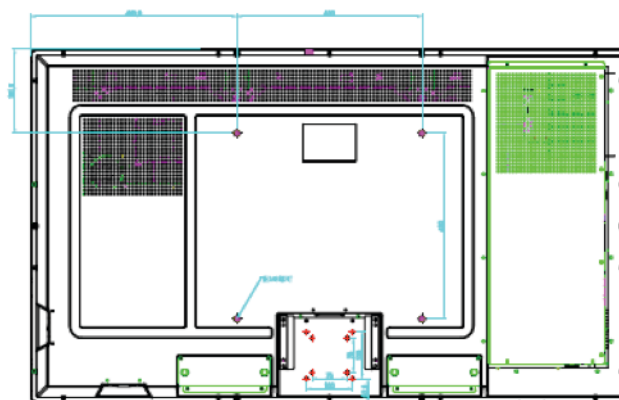

ACTIVPANEL HD 65" TECHNICAL DRAWING

FRONT

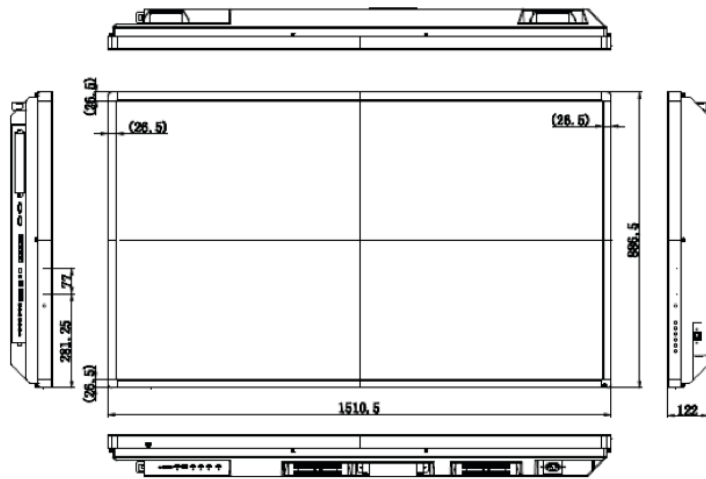

BACK

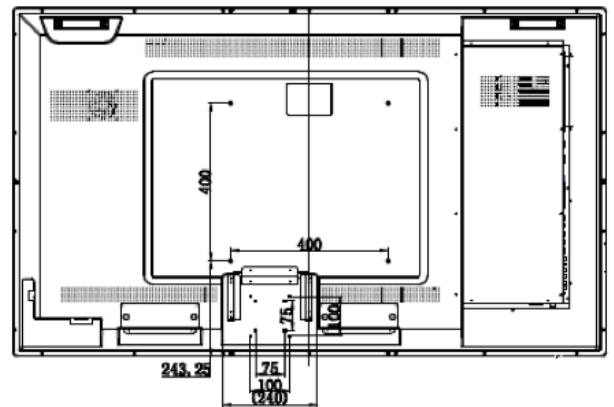

ACTIVPANEL HD 75" TECHNICAL DRAWING

FRONT

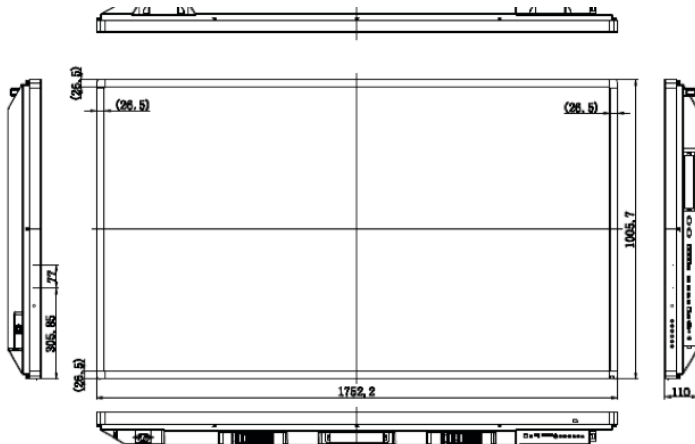

BACK

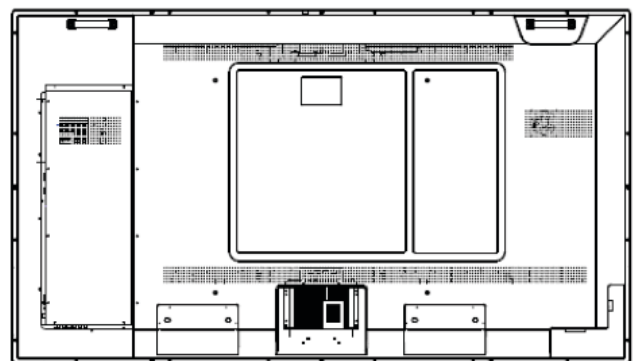

ACTIVPANEL 4K 84" TECHNICAL DRAWING

FRONT



BACK

